

AP0029

## 6.6 L Duramax® Fuel Filter Base Seal Kit Instruction Sheet

**Caution:** The hand primer pump and the fuel heater assembly are under spring pressure. Use caution during disassembly and assembly.

Step 1: Remove the fuel filter assembly from the engine and remove the filter from the base.

Step 2: Remove the hand primer assembly and remove the seals from the hand primer seal carrier (Figure 1).

Step 3: Remove the bleeder screw (Figure 1).

Step 4: Remove the fuel heater assembly (Figure 2).

Step 5: Clean and inspect the fuel filter base, fuel heater, hand primer and hand primer seal carrier for damage or cracks.

**Attention:** Use a suitable assembly lubricant when installing the new O-rings and seals. Refer to the back of this sheet for complete component orientation.

Step 6: Install the new O-rings and reinstall the fuel heater assembly.

Step 7: Install the new bleeder screw with the new O-ring.

Step 8: Install the new hand primer seals in the correct orientation (Figure 3).

Step 9: Install the new O-ring and reinstall the hand primer assembly.

Step 10: Reinstall the fuel filter base on the engine and install a new fuel filter.

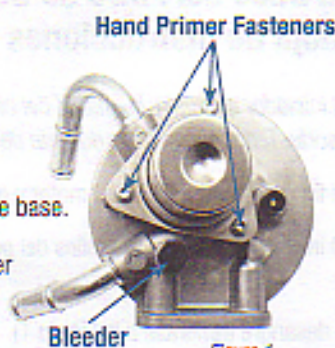

Figure 1

Figure 2

Figure 3

### Component Orientation

Denotes Items Included in the AP0029 Kit

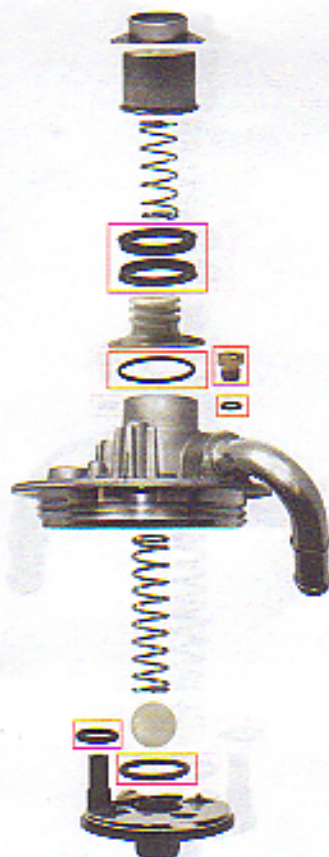

ALLIANT  
POWER

GOMER'S  
**USDIESEL** PARTS  
-COM